

60 GREENFIELD ROAD
KEYNSHAM
BRISTOL
BS31 1FL
OFFERS OVER £190,000



G R E G O R Y S
ESTATE AGENTS

OFFERED TO THE MARKET WITH NO ONWARD CHAIN CAN BE FOUND THIS CONTEMPORARY ONE BEDROOM APARTMENT, SITUATED ON THE POPULAR MEADOWS DEVELOPMENT.

Having undergone a thorough transformation by the current owners, this sizeable first floor apartment has been tastefully styled throughout with on trend décor, and statement fittings. The highlight of this apartment has to be the open plan kitchen/lounge, benefitting from a Juliette balcony to the leafy rear aspect, whilst the modern kitchen & Herringbone effect flooring make quite the impression. In addition to these features, a practical breakfast bar has been installed creating an ideal dining space in this modern home.

The primary bedroom also offers a generous space, complimented with a full height window to the rear, and a mirrored fitted double wardrobe offering valuable storage space. Further storage can be found in the hallway, which also benefits from being a generous size. Completing the internal offering is the modern three piece fitted bathroom, styled with contemporary tiles and statement matt black shower fittings & Crittall-style shower screen.

Outside, the property offers one allocated parking space to the front aspect, as well as use of the communal bike store, refuse store, and visitor parking spaces. Constructed circa 2016 by Messrs Taylor Wimpey, this modern apartment benefits from a remaining NHBC building warranty, whilst also offering an energy efficient build due to its age.

The Meadows development boasts an enviable position, within walking distance of Keynsham High St and Railway Station, whilst also being on the doorstep of scenic walks along Parkhouse Lane and the rolling countryside.

Sure to appeal to an array of viewers, this premium one bedroom apartment is a must view.





First Floor
651 sq.ft. (60.5 sq.m.) approx.

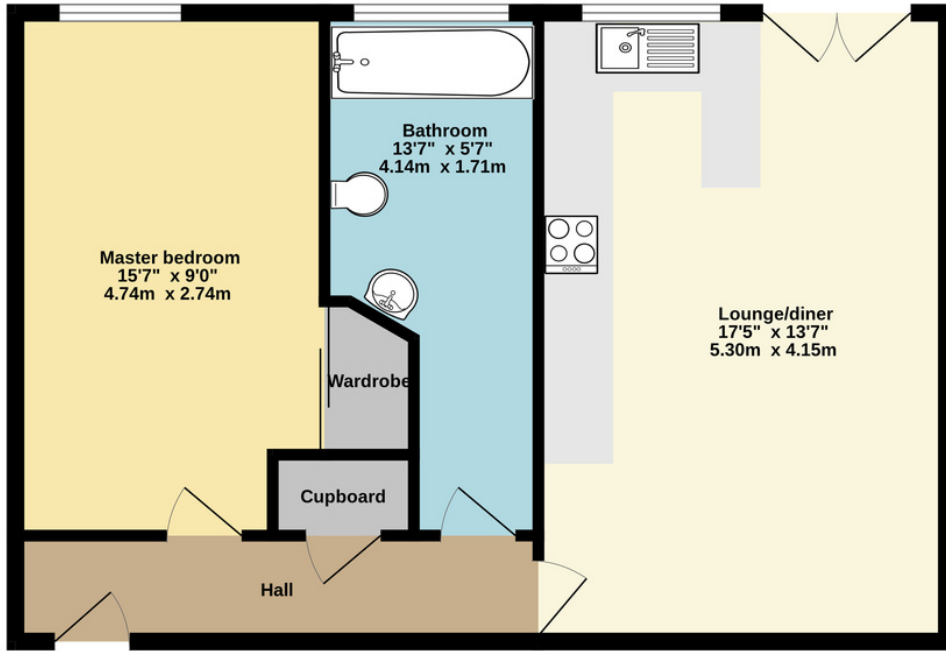

TOTAL FLOOR AREA: 651 sq.ft. (60.5 sq.m.) approx.
Whilst every attempt has been made to ensure the accuracy of the floorplan contained here, measurements of doors, windows, rooms and any other items are approximate and no responsibility is taken for any error, omission or mis-statement. This plan is for illustrative purposes only and should be used as such by any prospective purchaser. The services, systems and appliances shown have not been tested and no guarantee as to their operability or efficiency can be given.
Made with Metrofix ©2023

Energy performance certificate (EPC)

60, Greenfield Road Keynsham BRISTOL BS31 1FL	Energy rating B	Valid until: 12 January 2026
		Certificate number: 0843-3817-7097-9796-5581

Property type	Mid-floor flat
Total floor area	55 square metres

Rules on letting this property

Properties can be let if they have an energy rating from A to E.

You can read [guidance for landlords on the regulations and exemptions](https://www.gov.uk/guidance/domestic-private-rented-property-minimum-energy-efficiency-standard-landlord-guidance) (<https://www.gov.uk/guidance/domestic-private-rented-property-minimum-energy-efficiency-standard-landlord-guidance>)

Energy rating and score

This property's current energy rating is B. It has the potential to be B.

[See how to improve this property's energy efficiency.](#)

The graph shows this property's current and potential energy rating.

Properties get a rating from A (best) to G (worst) and a score. The better the rating and score, the lower your energy bills are likely to be.

For properties in England and Wales:

the average energy rating is D
the average energy score is 60

